

HOW-TO:

SET UP YOUR *NoodleTools* ACCOUNT

NoodleTools is River Dell's 1-stop tool for your research projects. Follow these step-by-step directions to set up your RD *NoodleTools* account.

1. Click here to go to the NoodleTools site >>> <https://www.noodletools.com/>
Click [Log In](#)

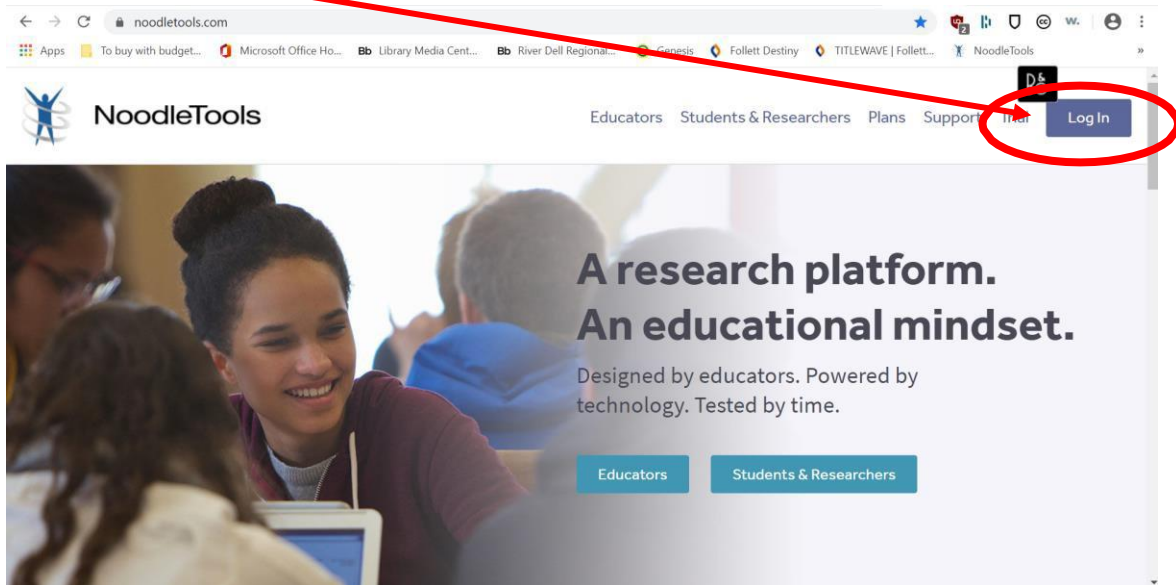

2. On the next page, click [REGISTER](#)

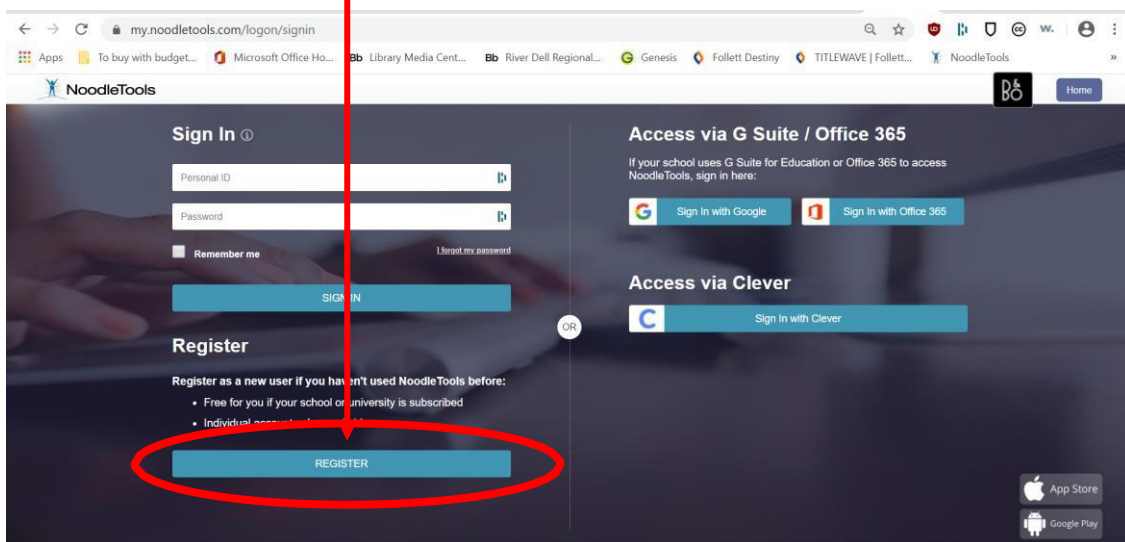

3. Where it says *'Please choose the type of account to create,'* this button should be selected: *'An account linked to a school/library subscription or trial'*

Enter the River Dell subscription login
School / Library username: *riverdell*
School / Library password: *hawks2021*
Press CONTINUE

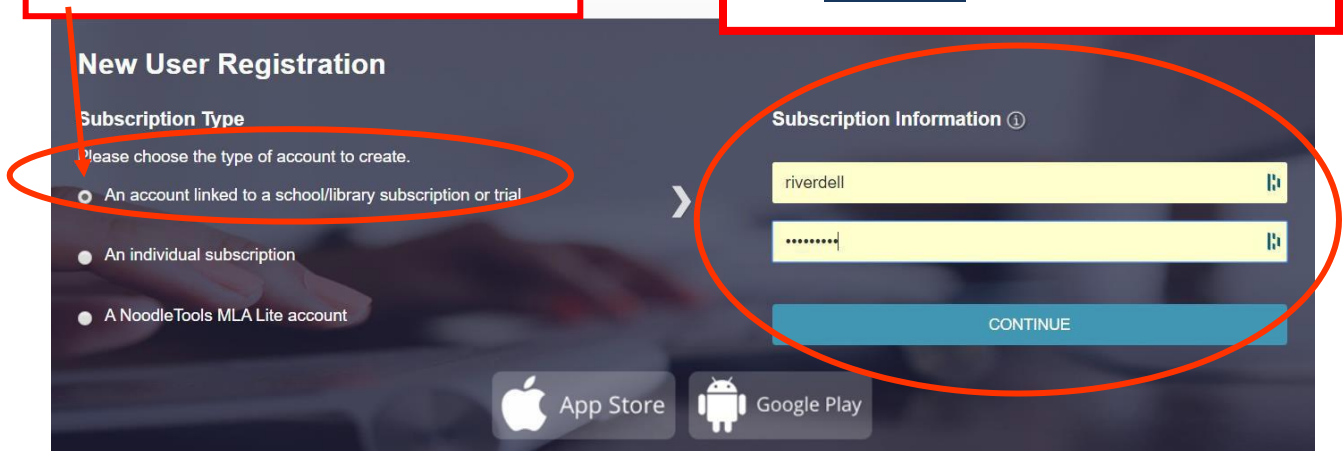

4. Now you are ready to set up your personal account.
Fill out the New User Registration page:

New User Registration

Subscription Type
Please choose the type of account to create.

- An account linked to a school/library subscription or trial
- An individual subscription
- A NoodleTools MLA Lite account

Subscription Information

riverdell

.....

CONTINUE

About You

- I am a student or library patron
- I am a teacher or librarian

School / location:

Expected year of graduation:

Choose a Personal ID

Personal ID

CHECK AVAILABILITY

Password

Retype Password

Easy Login Retrieval

Initials (e.g. "JS" for John Smith)

Phone Number (last 4 digits only)

REGISTER

Use this pull-down menu and select **River Dell Middle School** as your School / location.

The next pull-down menu will ask for your year of graduation from River Dell.

Type your **RD network ID** as your Personal ID – **lastnamefirstinitial##**

Type your 6-digit **RD Student ID #** as your password into both boxes.

For the 'Easy Login Retrieval' boxes, type in your **first and last initials** and the **last four digits of your phone number** (if you don't know it, just type in 1234)

Click **REGISTER**

- You are now ready to learn how to do bibliographic citations and take notes on NoodleTools!
- Save your **NoodleTools** username and password in a safe place.